

# CO7114 - AÉREO 0,40 M

Manual de Montagem  
 Assembly Instructions  
 Instrucción de Montaje

decibal®

Produto Montado  
 Producto final  
 Assembled

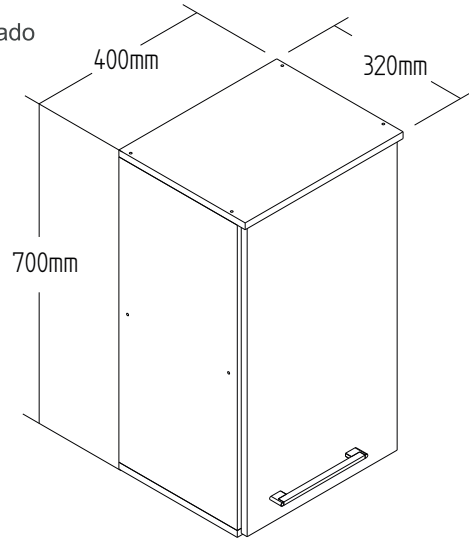

Verificar o lado deseado antes de efetuar a montagem  
 Check the desired side before mounting  
 Compruebe el lado deseado antes de montar

01°

C2 12 UNI

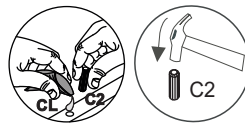
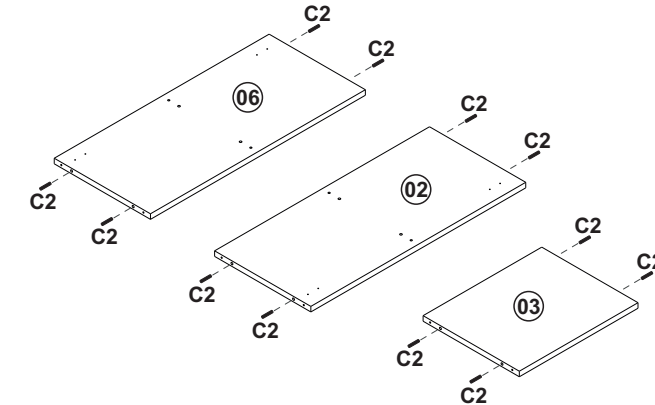

02°

P7 4 UNI

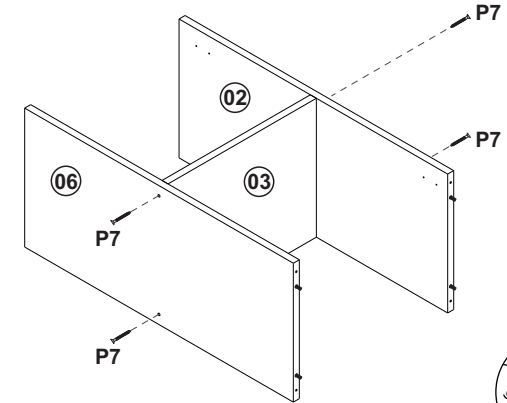

03°

P7 8 UNI

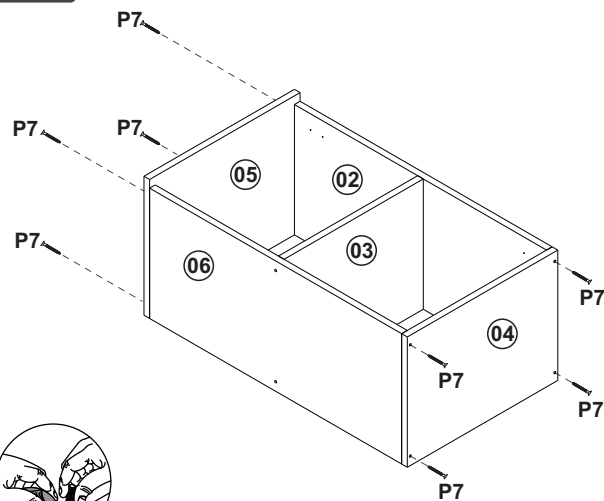

04°

COSTA/REVÉS/BACK

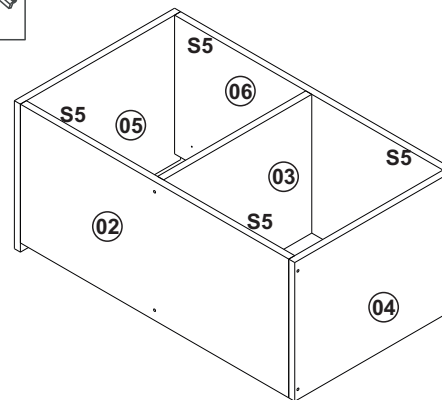
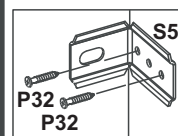

05°

COSTA/REVÉS/BACK

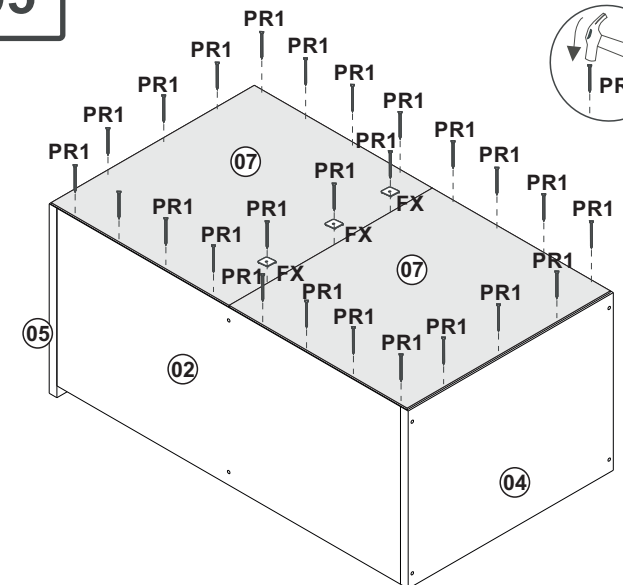

# CO7114 - AÉREO 0,40 M

Manual de Montagem  
Assembly Instructions  
Instrucción de Montaje

decibal<sup>®</sup>  
móveis

6°



**PESO SUPORTADO.  
PESO SOPORTADO.  
WEIGHT SUPPORTED.**

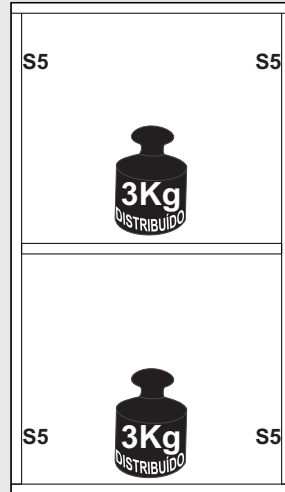
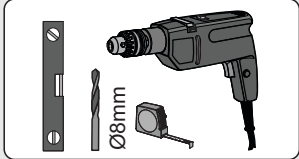

Fixação parede  
Fixed in the wall

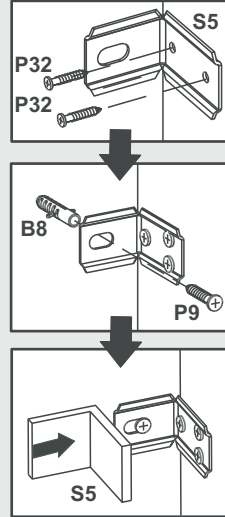

7°

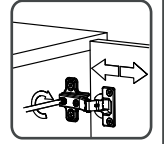
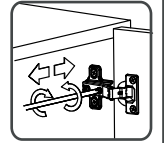
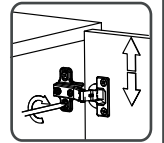
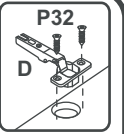
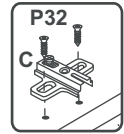
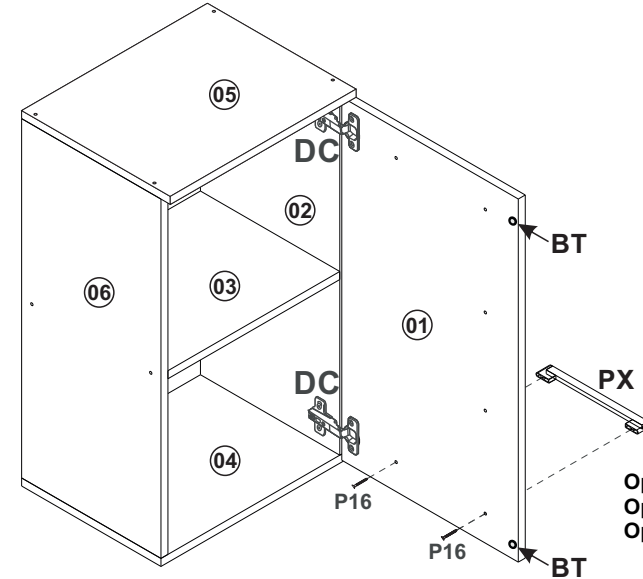

Opção 1.  
Opción 1.  
Option 1.

## Relação de Peças/ Relación de Piezas/Parts List

N°	CÓDIGO/CODE	DESCRIÇÃO/DESCRIPCIÓN/DESCRIPTION	QTD/CANT	VOL.
1	0569352	PORTA/PUERTA/DOOR	677X380X15MM	1
2	0569350	LATERAL DIR/LATERAL/SIDE	670X300X15MM	1
3	0569353	PRATELEIRA/ESTANTE/SHELF	370X300X15MM	1
4	0569354	BASE	400X300X15MM	1
5	0569349	TAMPO/TAPA/TOP	400X320X15MM	1
6	0569351	LATERAL ESQ/ESTANTE/SHELF	670X300X15MM	1
7	0569355	COSTA/REVÉS/BACK	396X347X2, 8MM	2

**ATENÇÃO!!!!** montadores e consumidores

\* Ajustar o torque da parafusadeira para não danificar as peças escareando o parafuso \*

**ATENCIÓN!!!!** montadores e consumidores

\* Ajuste el torque del destornillador para no dañar las piezas avallanando el tornillo \*

**ATTENTION!!!!** assemblers and consumers

\* Adjust the torque of the screwdriver so as not to damage the parts by countersinking the screw \*



Atenção! verificar a posição adequada do puxador antes de efetuar a montagem.  
¡Atención! Compruebe la posición adecuada del mango antes del montaje.  
Attention! Check the proper position of the handle before assembling.

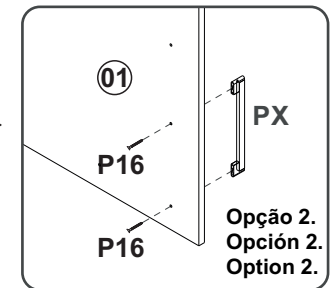
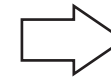
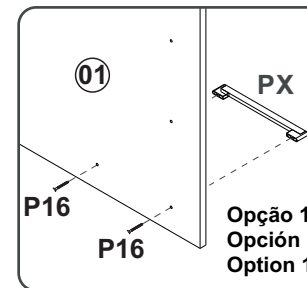

Ou  
O.  
Or.



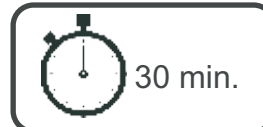











www.decibal.com.br



# CO7114 - AÉREO 0,40 M

Manual de Montagem  
Assembly Instructions  
Instrucción de Montaje

**decibal**<sup>®</sup>  
móveis

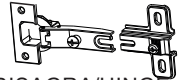
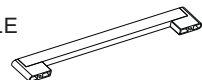
Escala (1:1)		Ferragens/ Herrajes/ Hardware		Escala (N/A)			
LEGENDA	DESCRIÇÃO/DESCRIPCIÓN/DESCRIPTION	CÓDIGO	QUANT.	LEGENDA	DESCRIÇÃO/DESCRIPCIÓN/DESCRIPTION	CÓDIGO	QUANT.
<b>P7</b>	 PARAFUSO/TORNILLO/SCREW 4X45	01318	<b>12</b>	<b>CL</b>	 COLA/PEGAMENTO/GLUE	01213	<b>01</b>
<b>P9</b>	 PARAFUSO/TORNILLO/SCREW 6X50	03827	<b>04</b>	<b>ET</b>	 ETIQUETA LOGO DECIBAL/LABEL DECIBAL	01312	<b>01</b>
<b>P16</b>	 PARAFUSO/TORNILLO/SCREW 3,5X25	09955	<b>02</b>	<b>B8</b>	 BUCHA/BUJE/BUCHING ( 8mm)	01311	<b>04</b>
<b>P32</b>	 PARAFUSO/TORNILLO/SCREW 4X14	12412	<b>20</b>	<b>S5</b>	 SUPORTE AÉREO/APOYO AÉREO/AIR SUPPORT	03828	<b>04</b>
<b>C2</b>	 CAVILHA/TARUGO/DOWEL 6X30 MM	01211	<b>14</b>	<b>FX</b>	 FIXADOR COSTA/FIJADOR FONDO/FIXER COAST	01331	<b>03</b>
<b>PU</b>	 PARAFUSO UNIÃO/UNIÓN DETORNILLO /SCREW UNION	01495	<b>02</b>	<b>AD</b>	 ADESIVO/ADHESIVO/ADHESIVE	15mm	<b>08</b>
<b>PR1</b>	 PREGO/CLAVO/NAIL 10X10	01330	<b>35</b>	<b>BT</b>	 BATENTE/BATIENTE DE SILICONA/SILICONE STOP 8MM	02921	<b>02</b>
				<b>DC</b>	 DOBRADIÇA/BISAGRA/HINGE D=35mm C= Alta	12615 (Amortecimento)	<b>02</b>
				<b>PX</b>	 PUXADOR/PEGADOR /HANDLE SEVILHA NEW GOLD 192 MM	13106	<b>01</b>

### ATENÇÃO!!!! montadores e consumidores

\* Para limpar o móveis utilize somente um pano úmido (umedecido em água pura ou água com sabão neutro). Depois, passe um pano seco. Evite a umidade excessiva.  
\* Evite usar álcool, água sanitária, detergente e outros produtos químicos, mesmo diluídos em água. Não utilize produtos abrasivos de nenhuma espécie

### ATENCIÓN!!!! montadores e consumidores

\* Para limpiar el mueble utilice solamente un paño húmedo (humedecido con agua limpia o con un jabón suave). A continuación, utilice un paño seco. Evite el exceso de humedad.  
\* Evite uso de alcohol, hipocloritro solución basada, detergente y otros productos químicos, mismo diluídos en agua.  
\* No utilice productos abrasivos de ningún tipo.

### ATTENTION!!!! assemblers and consumers

\*To clean the furniture, use only a damp cloth (humidify it only in pure water or water and neutral soap).After, use a dry cloth.Avoid excessive humidity.  
\*Avoid using alcohol, bleach, detergent and other chemical products, even diluted in water. Do not use any kind of abrasive cleaning agents to clean the furniture.  
The use of such products may jeopardize the ?nal characteristics of the furniture.

Ferramentas necessárias  
Necessary tools  
Herramientas necesarias

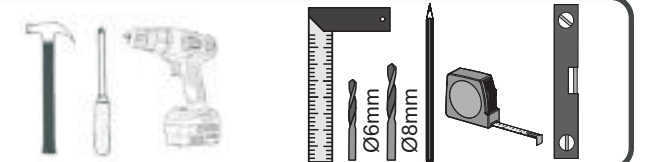

Medida em mm

