

Multiuso/Multifunctional SEUL BC-5275

Lote: 000000

MANUAL DE MONTAGEM
INSTRUCCIONES DE ARMADO
ASSEMBLY INSTRUCTIONS

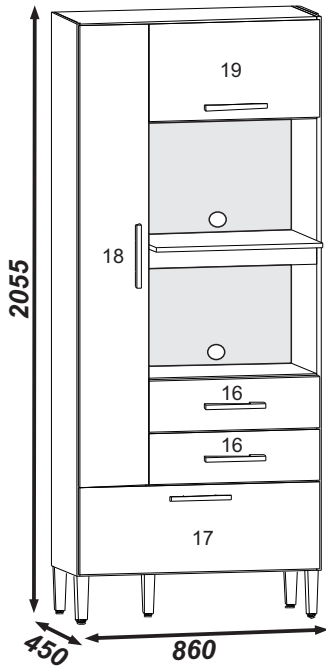

- POC**
- 01-LATERAL ESQUERDA
 - 02-LATERAL DIREITA
 - 03-DIVISÓRIA
 - 04-TAMPO SUPERIOR
 - 05-TAMPO INFERIOR
 - 06-TAMPO INFERIOR ESQUERDO
 - 07-PRATELEIRA ESQUERDA (2x)
 - 08-LATERAL DE GAVETA (2x)
 - 09-TRASEIRO DE GAVETA
 - 10-TAMPO SUPERIOR DIREITO (2x)
 - 12-TRAVESSA TAMPO FORNO
 - 14-TAMPO MICRO
 - 15-TAMPO FORNO
 - 16-FRENTE DE GAVETA
 - 17-PORTA INFERIOR
 - 18-PORTA ESQUERDA
 - 19-PORTA SUPERIOR
 - 20-COSTA ESQUERDA
 - 21-COSTA INFERIOR (2x)
 - 22-COSTA MICRO
 - 23-COSTA FORNO
 - 25-COSTA SUPERIOR
 - 26-FUNDO DE GAVETA

- LD**
- 01-LATERAL IZQUIERDA
 - 02-LATERAL DERECHA
 - 03-DIVISION
 - 04-TAPA SUPERIOR
 - 05-TAPA INFERIOR
 - 06-TAPA INFERIOR IZQUIERDO
 - 07-ESTANTE IZQUIERDA (2x)
 - 08-LATERAL DEL CAJÓN (2x)
 - 09-TRASERO DEL CAJÓN
 - 10-TAPA SUPERIOR DERECHO (2x)
 - 12-TRAVESAÑO TAPA HORNO
 - 14-TAPA MICRO
 - 15-TAPA HORNO
 - 16-FRENTE DEL CAJÓN
 - 17-PUERTA INFERIOR
 - 18-PUERTA IZQUIERDA
 - 19-PUERTA SUPERIOR
 - 20-DORSO IZQUIERDA
 - 21-DORSO INFERIOR (2x)
 - 22-DORSO MICRO
 - 23-DORSO HORNO
 - 25-DORSO SUPERIOR
 - 26-FONDO DEL CAJÓN

- LD**
- 01-LEFT SIDE
 - 02-RIGHT SIDE
 - 03-DIVIDER
 - 04-UPPER TOP
 - 05-LOWER TOP
 - 06-LEFT LOWER TOP
 - 07-LEFT SHELF (2x)
 - 08-DRAWER SIDE (2x)
 - 09-DRAWER BACK
 - 10-RIGHT UPPER TOP (2x)
 - 12-OVEN TOP CROSSBAR
 - 14-MICRO TOP
 - 15-OVEN TOP
 - 16-DRAWER FRONT
 - 17-LOWER DOOR
 - 18-LEFT DOOR
 - 19-UPPER DOOR
 - 20-LEFT BACK PANEL
 - 21-LOWER BACK PANEL (2x)
 - 22-MICRO BACK PANEL
 - 23-OVEN BACK PANEL
 - 25-UPPER BACK PANEL
 - 26-DRAWER BOOTOM

DIMENSÕES PEÇAS PRONTAS
DIMENSIONES DE LAS PEZAS PRONTAS
DIMENSIONS READY MODE PARTS

- 01-1895 X 360 X 12
- 02-1895 X 360 X 15
- 03-1871 X 359 X 12
- 04-834 X 359 X 12
- 05-834 X 359 X 12
- 06-233 X 359 X 12
- 07-233 X 299 X 12
- 08-338 X 95 X 12
- 09-541 X 65 X 12
- 10-589 X 359 X 12
- 12-589 X 65 X 15
- 14-589 X 359 X 15
- 15-589 X 450 X 15
- 16-597 X 177 X 15
- 17-842 X 297 X 15
- 18-1578 X 241 X 15
- 19-597 X 332 X 15
- 20-1892 X 247 X 3
- 21-605 X 333 X 3
- 22-605 X 455 X 3
- 23-605 X 431 X 3
- 25-605 X 341 X 3
- 26-563 X 341 X 3

Ferragens/Herraje/Hardware:

330	A	Cavilhas 6 x 30 Wood Peg		46
0289	B	Parafuso 3,5 x 40 Tornillo Screw		34
-----	C	Puxador 192 mm CROMADO Tirador Handle		05
0285	D	Parafuso 3,5 x 25 flangeado Tornillo Screw		12
0477	E	Cola Pegamento Glue		01
0283	G	Parafuso 3,5 x 12 c/c Tornillo Screw		76
0296	H	Taxa 10 x 7 Clavo 10 x 7 Nail 10 x 7		80
151	I	Dobradiça metal Bisagra Hinge		08
0538	J	Porca cilíndrica Tuerca cilíndrica Cylindrical nut		10
0438	K	Cantoneira Esquinera Cantoneira		10
-----	L	Pés Pies Feet		05
0555	M	Parafuso 5 X 50 Tornillo Screw		05
0279	N	Fixador De Costa Fixador de Espalda Fix Back		21
1549	P	Articulador Articulador Articulator		02
3049	Q	Corrediça metálica slim 350mm Rieles Slides		02
4738	R	Cantoneira Plástica Refuerzo de plástico Plastic gusset		02
0286	S	Parafuso 3,5 x 22 c/c Tornillo Screw		02
0744	T	Taxa 13 x 15 Clavo 13 x 15 Nail 13 x 15		08
-----	U	Perfil 588 mm Perfil Profile		01

Instruções para a montagem do produto:

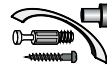

Separe as peças e acessórios de maneira organizada.
Separate the parts and accessories in an organized way.
Separe las piezas y accesorios de forma organizada

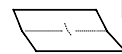
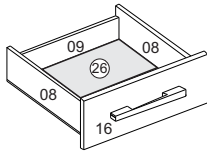

Forrar o chão com o papelão das embalagens.
Cover the floor with the cardboard from the pack.
Cubra el suelo con el papelón de los embalajes.



É necessário duas pessoas para montar o produto.
It's necessary two people to assembly the product.
Se requiere dos personas para montar el producto.

Ferramentas necessárias (não fornecidas)

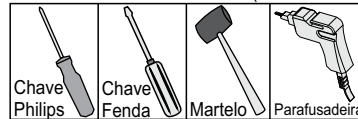

medidas em mm

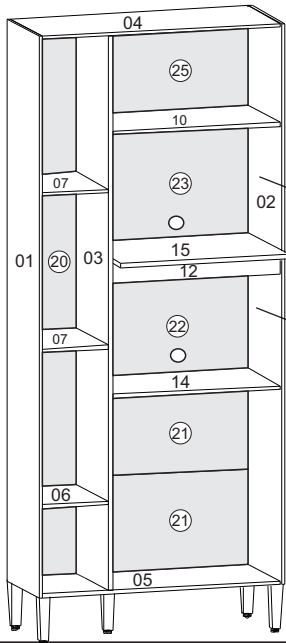

ESPAÇO LIVRE
589 X 420

ESPAÇO LIVRE
589 X 375

Parafuso 3,5 x 25 c/c opcional para juntar os modulo.
Tornillo 3,5 x 25 c/c opcional para unificar los modulos.
Optional 3,5 x 25 c/c for joining modules.

Montagem da gaveta
Armado de los cajones
Drawer Assembly

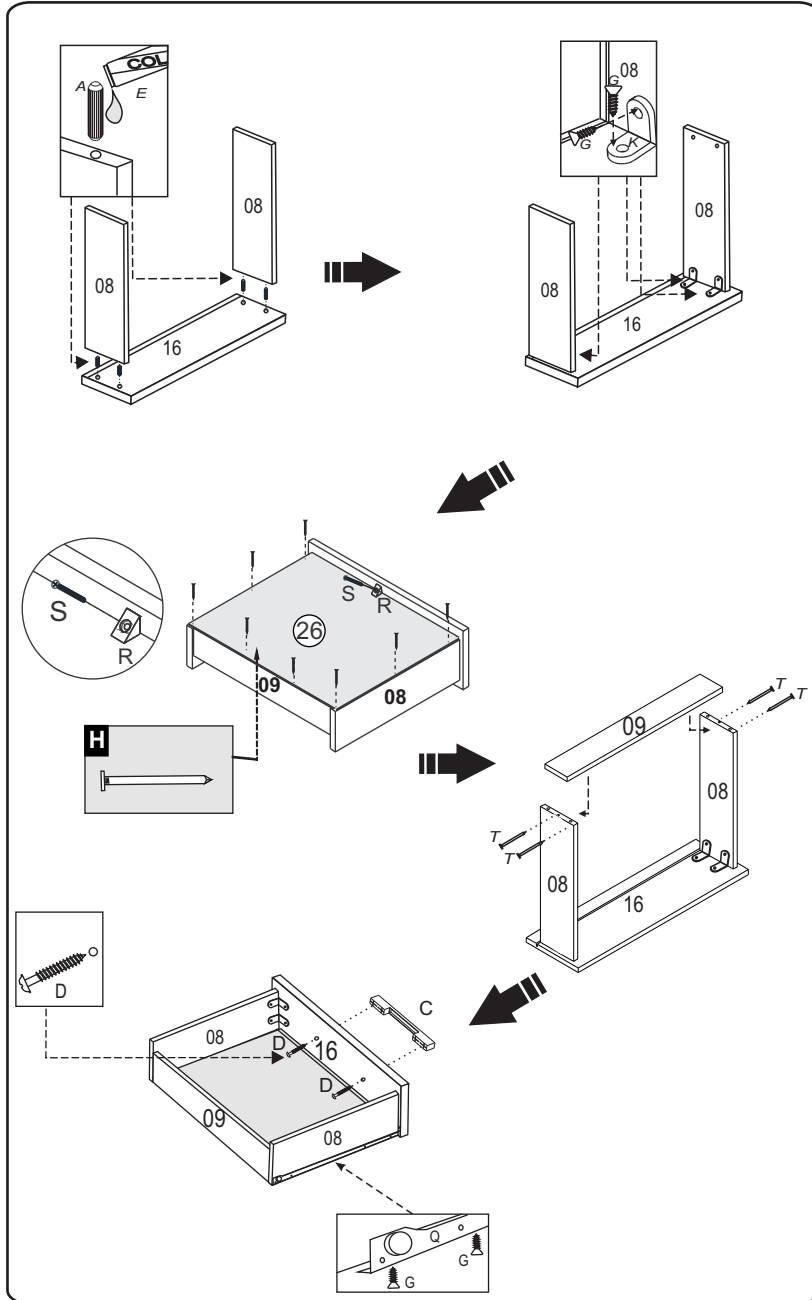

1º Passo
1º Paso
1º Step

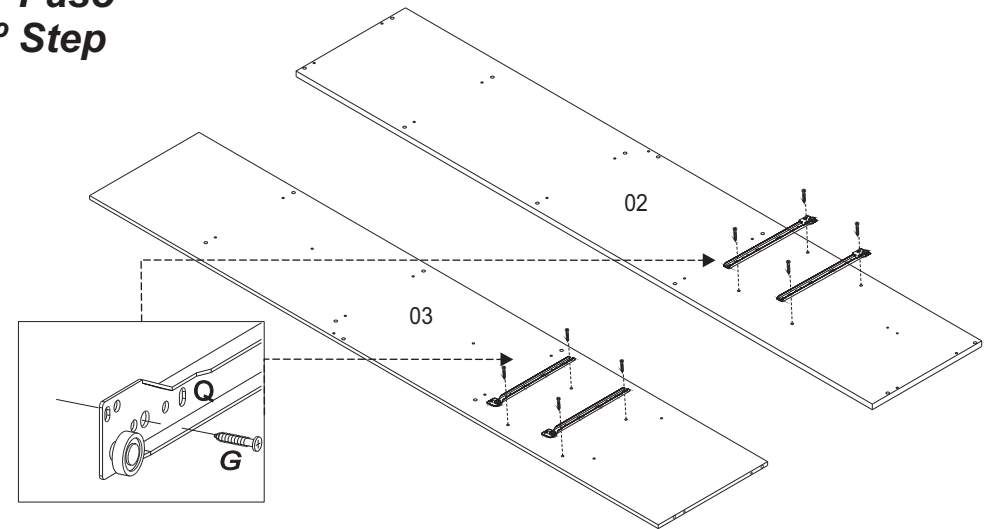

Atenção! ao parafusar a correia **Atención! al atornillar la corredera,** **Attention! When screwing the slide,**
,cuidar o lado certo. **cuidar para que esté en el lado correcto** **take care to do the right side**

2º Passo
2º Paso
2º Step

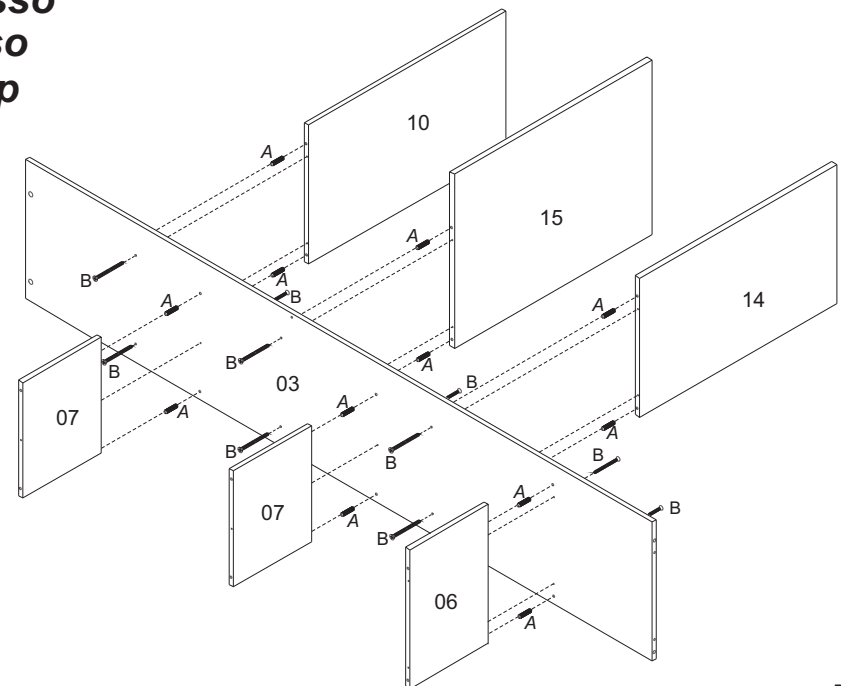

3° Passo

3° Paso

3° Step

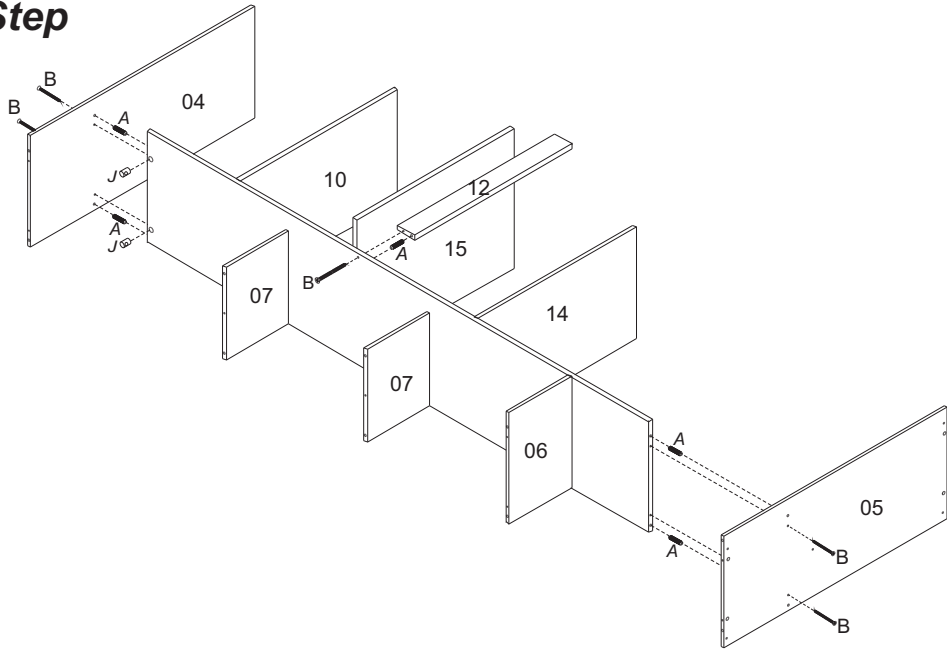

4° Passo

4° Paso

4° Step

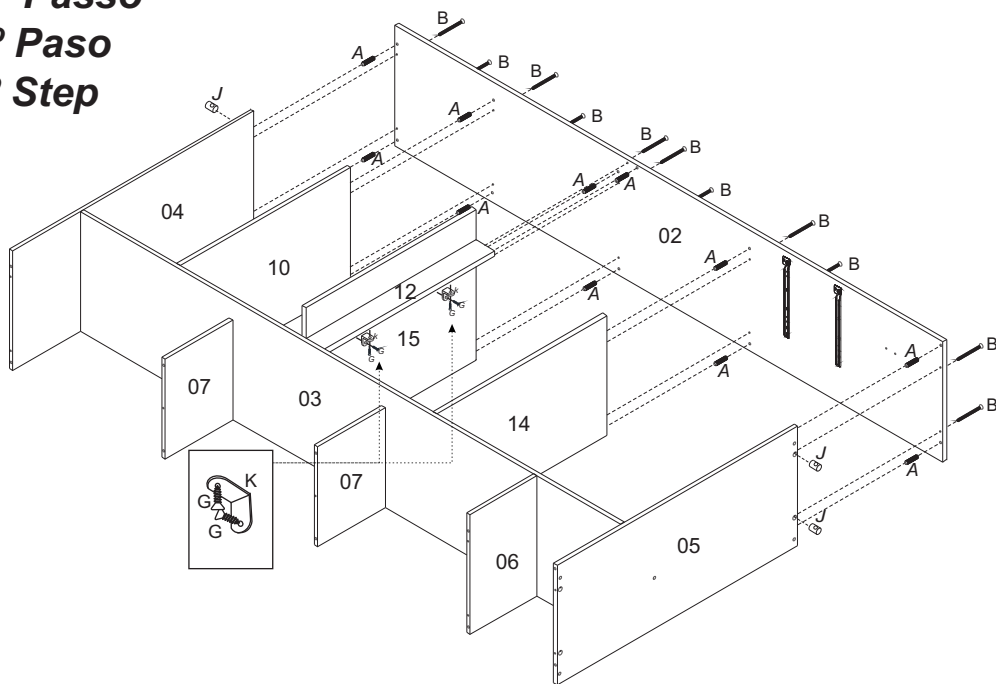

5° Passo

5° Paso

5° Step

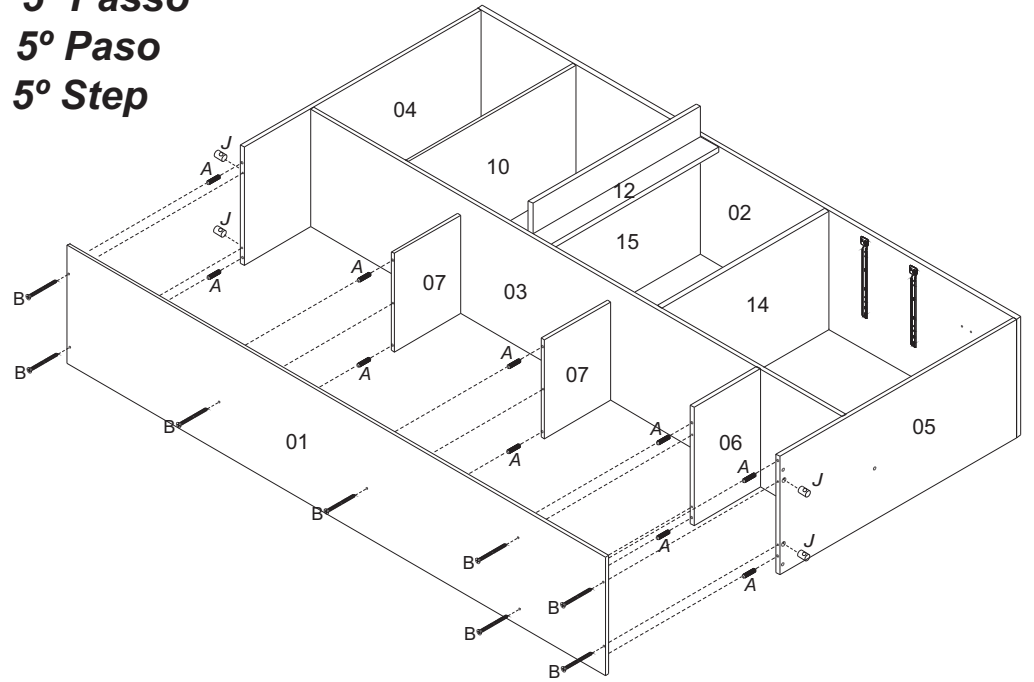

6° Passo

6° Paso

6° Step

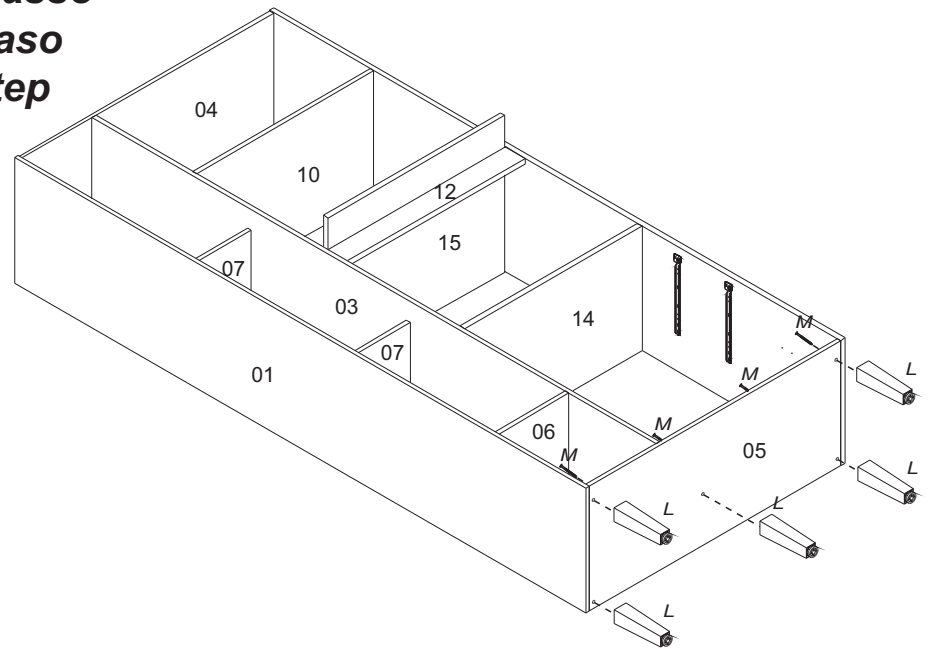

7º Passo
7º Paso
7º Step

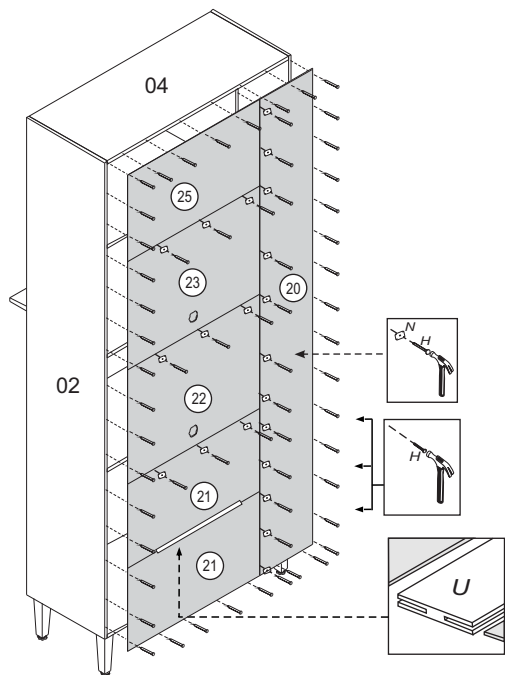

8º Passo
8º Paso
8º Step

Montagem das dobradiças nas portas (17,18,19) colocando calço e dobradiça.
 Montaje de las bisagras en las puertas (17,18,19) Poner la base y bisagra.
 The assembly of the Hinge in the door (17,18,19) putting the base of Hinge and hinge .

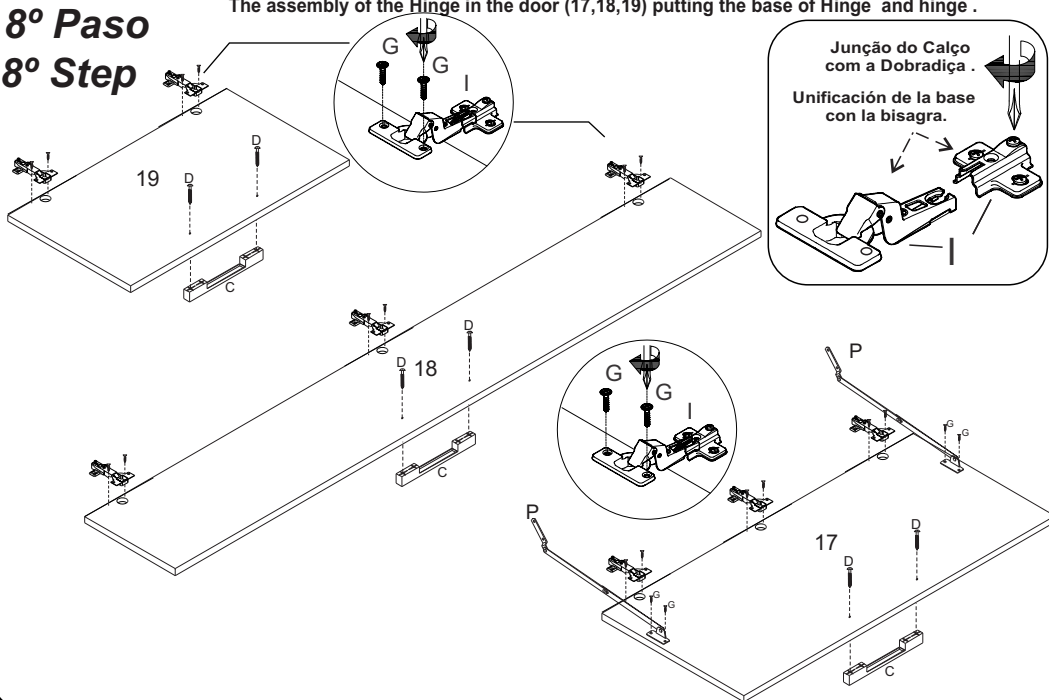

9º Passo
9º Paso
9º Step

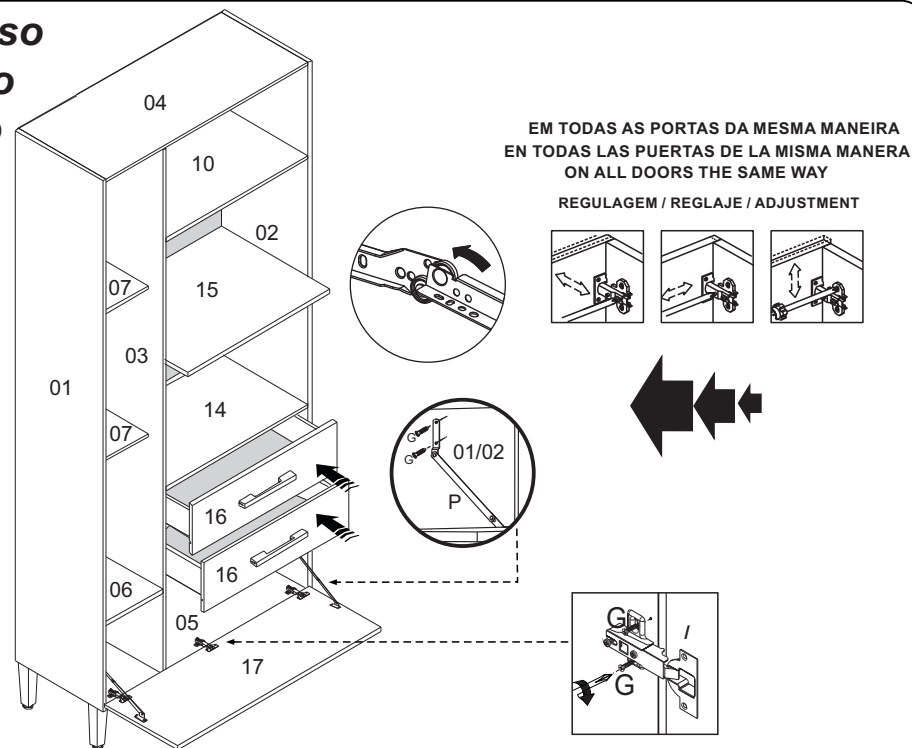

EM TODAS AS PORTAS DA MESMA MANEIRA
 EN TODAS LAS PUERTAS DE LA MISMA MANERA
 ON ALL DOORS THE SAME WAY

REGULAGEM / REGLAJE / ADJUSTMENT

10º Passo
10º Paso
10º Step

EM TODAS AS PORTAS DA MESMA MANEIRA
 EN TODAS LAS PUERTAS DE LA MISMA MANERA
 ON ALL DOORS THE SAME WAY

REGULAGEM / REGLAJE / ADJUSTMENT

